

# INSTALLATION INSTRUCTIONS FOR UNIVERSAL WASHER VALVE PART NO. WV-1

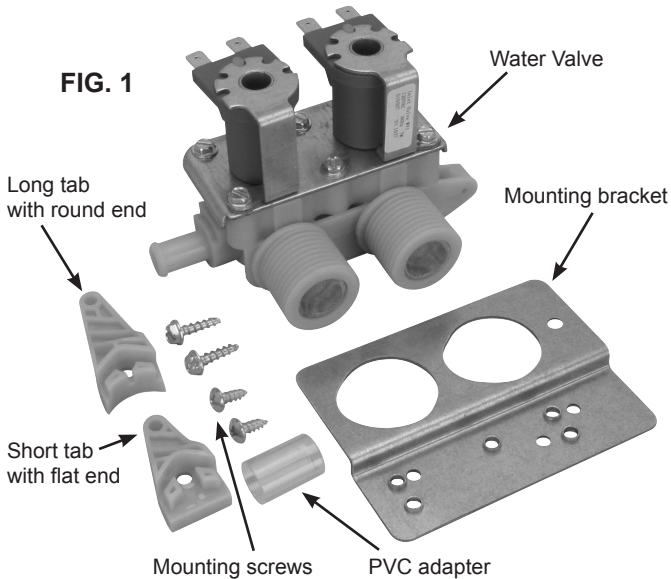

## WARNING! Electrical Shock Hazard

To avoid risk of electrical shock, personal injury or death; disconnect electrical power before servicing.



Familiarize yourself with everything that comes in this kit. See Figure 1.

1. Determine the position of the solenoids on the original valve. If needed, rotate the solenoids on the new valve by loosening the 1/4" screw and pull the solenoid lock down bracket up. Rotate the solenoid to the notch closest to the position of the solenoid on the original valve. Tighten the lockdown bracket screw, using caution to not overtighten. See Figure 2.
2. If the outlet size is 1/2", use the PVC adapter included by sliding it over the 3/8" outlet on the valve. See Figure 2.

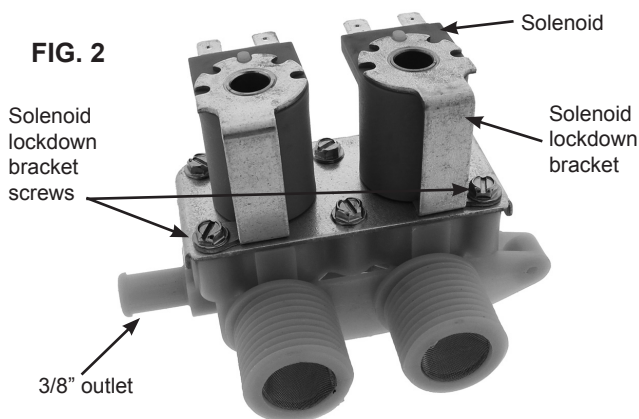

### 3. Single Screw Mount

Once the solenoids match the same position as the original valve, mount the valve into the machine in the same position as the original. Use the original mounting screw to secure the valve.

### 4. Mounting Bracket (See Figure 3)

Fit the mounting bracket over valve inlet. Seat the bracket to the right into the slot molded into the valve body aligning the screw hole on the far right for the bracket. Secure the bracket using the supplied screw. This bracket has several mounting holes. Choose the mounting holes that allow the valve to mount in the same position as the original valve. Mount the valve into the washer using original screws.

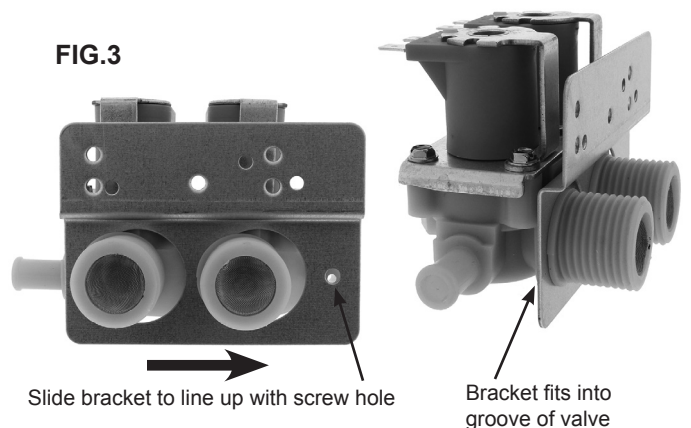

### 5. GE Tab (See Figure 4)

Mount the long tab with round end to the end of the valve. Mount the short tab with the flat end to the side of the valve. Secure mounting tabs with supplied screws. Mount the valve into the washer using original screws.

